

General specifications	
Spa weight (empty)	229 Kg
Spa weight (full)	1.009 Kg

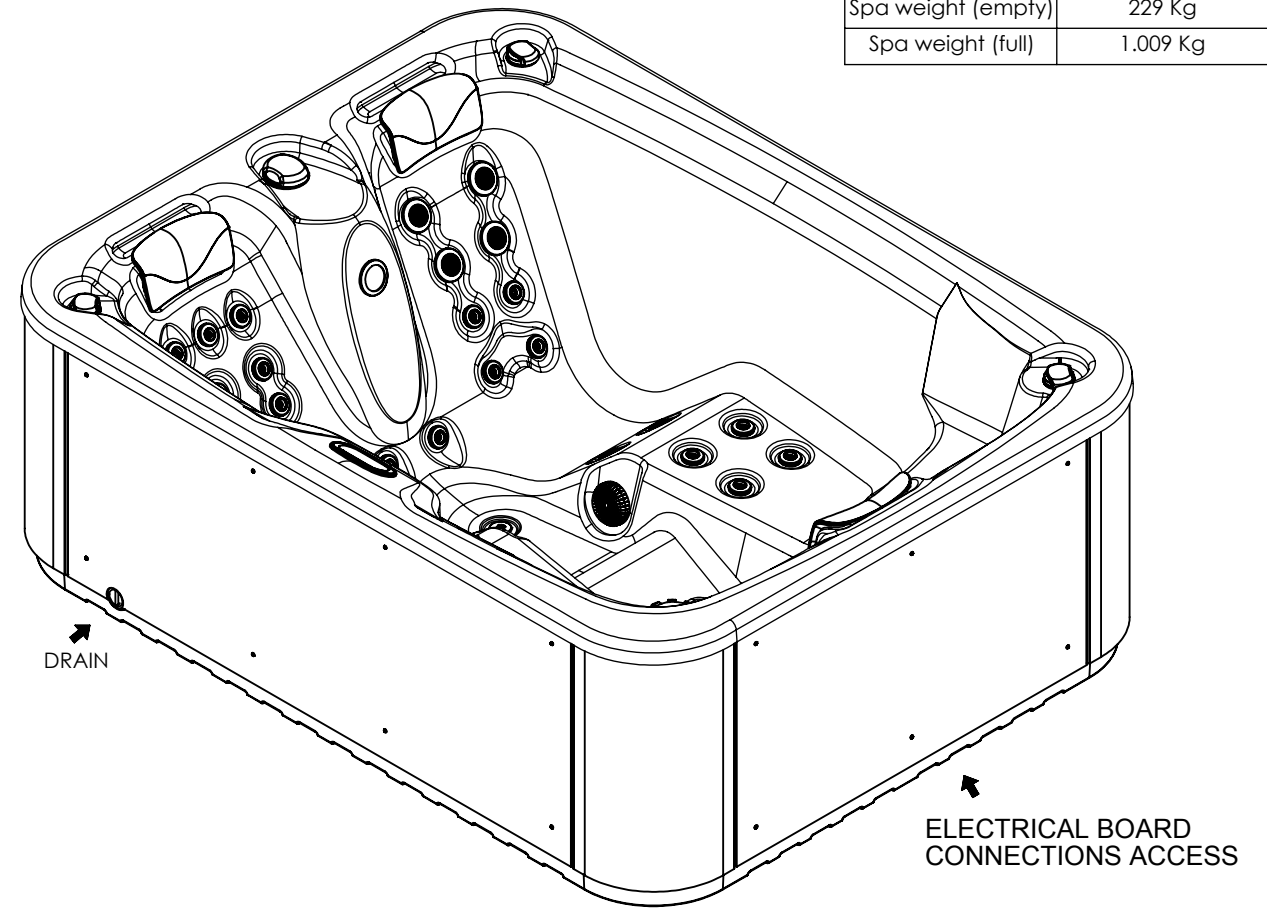

ELECTRICAL BOARD CONNECTIONS ACCESS

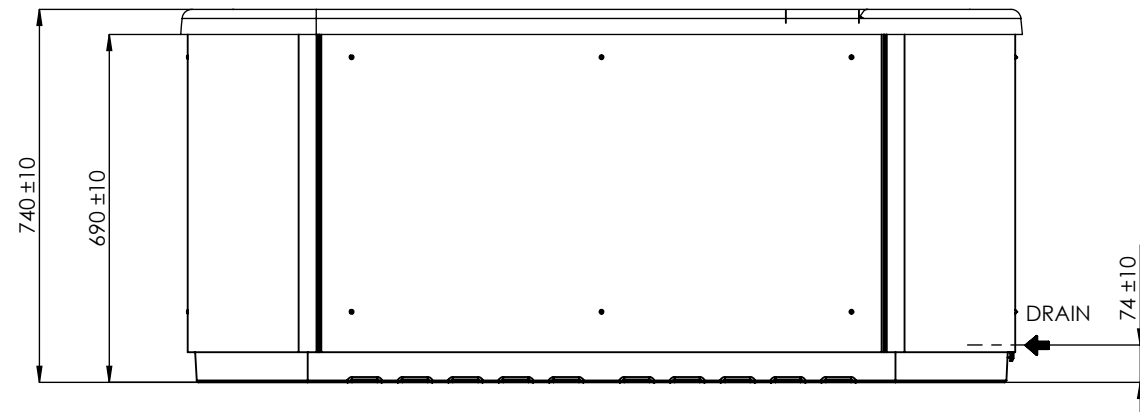
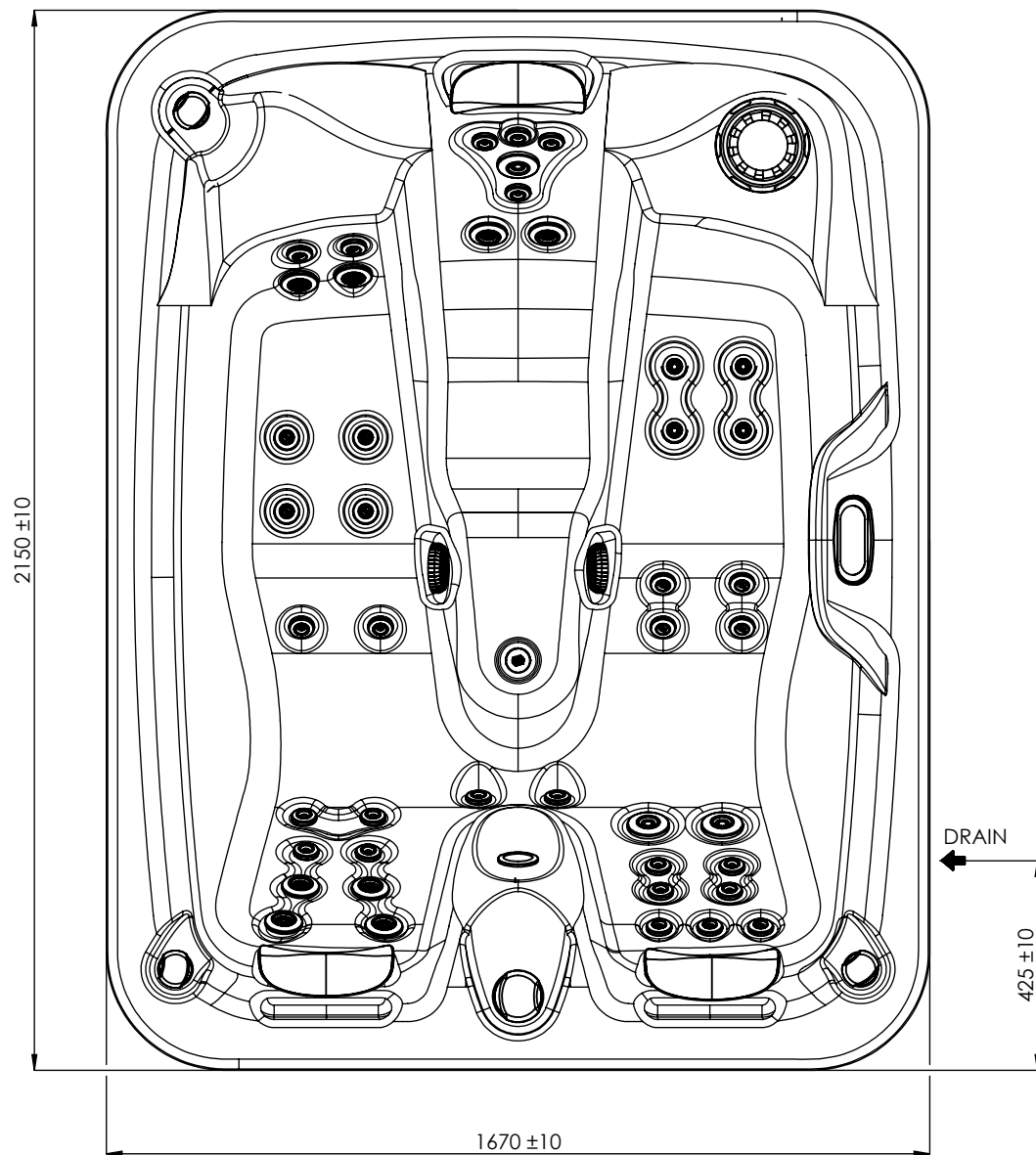

Inground option

WARNING:
It's essential to keep a minimum clearance access of **700mm** all around.

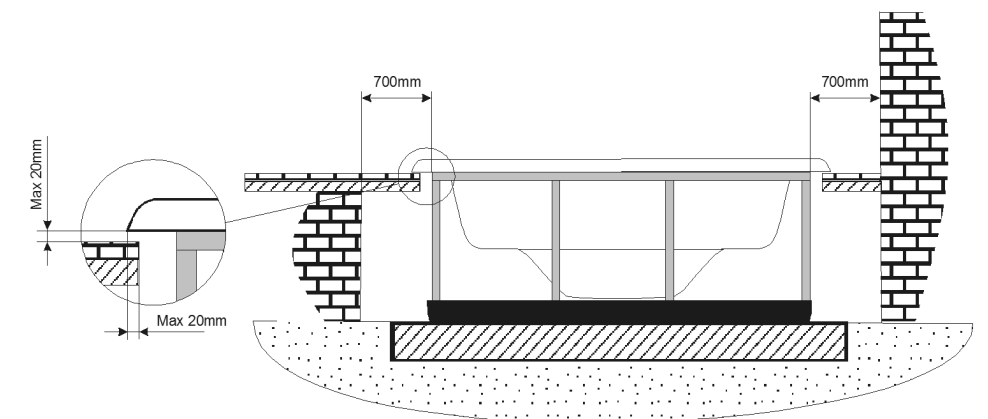

VALID FROM SERIAL NUMBER: **53730**
VALIDO A PARTIR DEL NÚMERO DE SERIE: **53730**

According to our policy of continuous improvement, dimensions, features or components of this product can be partially or completely changed without prior notice.
It's Customer responsibility to verify that this is the last version of the drawing

04	17/12/2018	D.Castillo	Spa weight added.
03	25/06/2018	A.Miquel	Jets changed (CMP).
02	17/07/2017	V.Saiz	Update position of Electrical Board Connections Acces
01	10/05/2017	O. Faura	Changing of electronic parts references.
Change No.	Date	Name	Modification
Remarks			COMMERCIAL
Dimensions in mm. General Tolerances +/- 10mm			
Drawn	15/03/2017	O. Faura	
Checked	15/03/2017	V. Saiz	
Scale	1:15	General Tolerance	Part Number
Sheet	1/3	DIN 7168 ISO 2768g	
			69121
			Rev.
			04
			First Angle Projection
Property of IBERSPA S.L. Avda. Pla d'Urgell 2-8 25200 Cervera, Spain. Don't use without permission. Keep this information confidential and use it solely for the permitted purpose.			